

Thank you for choosing the NewTec WiFi solution.

In addition to the high audio quality, the NewTec WiFi solution is characterized by a very simple and uncomplicated installation. The basic principle is that one Transmitter provides, within the transmitter range, an unlimited number of WiFi speakers.

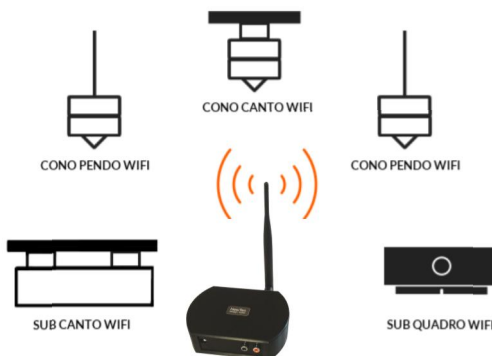

IMPORTANT BEFORE STARTING THE INSTALLATION:

Please check if there are visible damages caused by transportation. In this case, do not install the system but contact your supplier.

Power connection of the different WiFi speakers

CONO canto WiFi

CONO pendo WiFi

WiFi Subwoofer

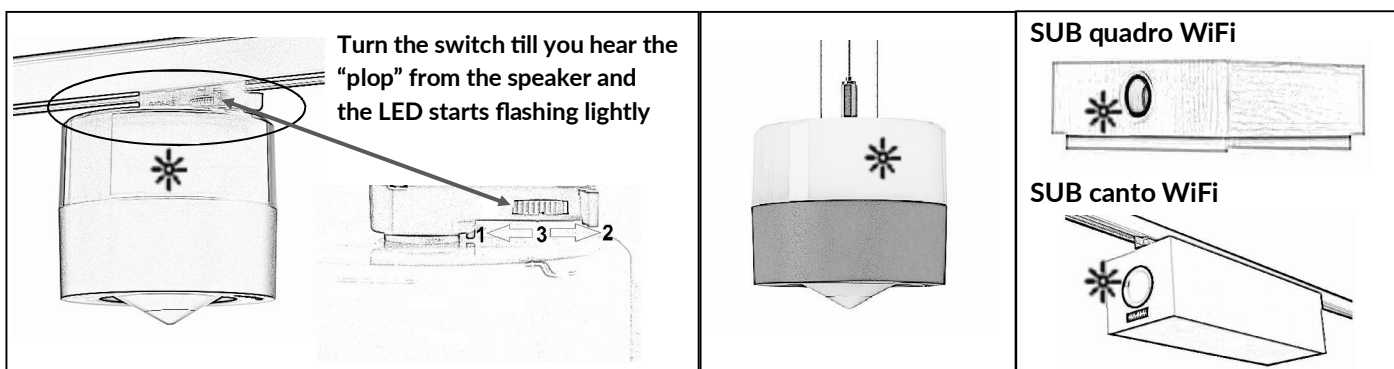

Connect all the speakers to the power supply. When the * LED is flashing, the speaker is operational.

NEWTEC TRANSMITTER

Front

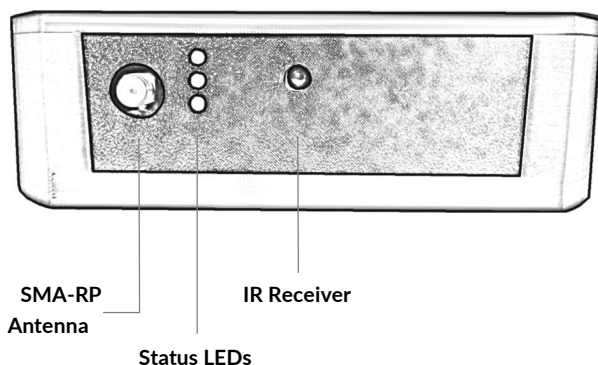

Back

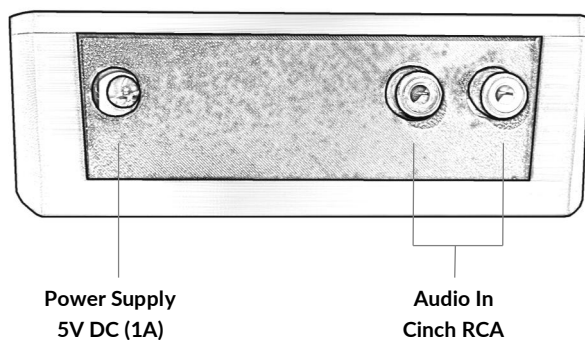

NEWTEC REMOTE CONTROL

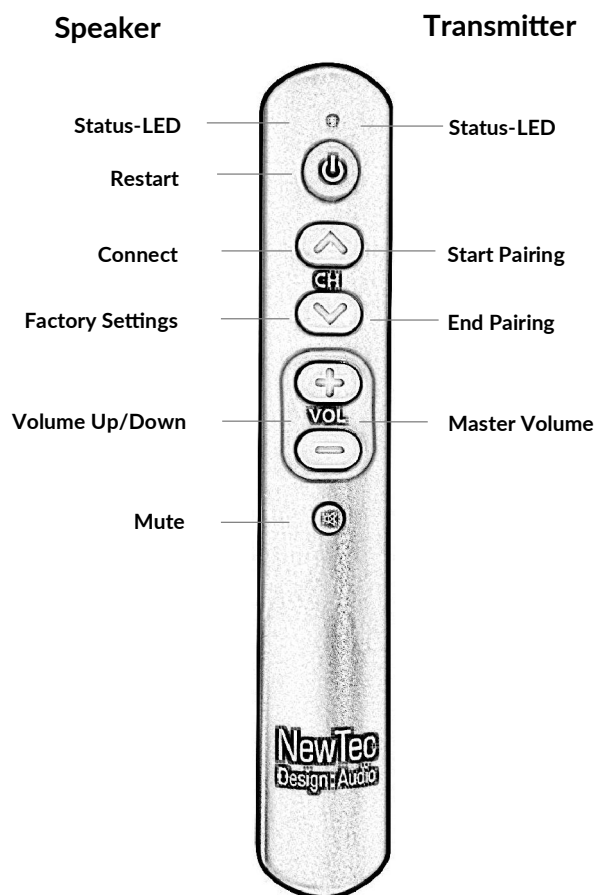

IMPORTANT: The remote is used to control the transmitter, as well as the individual speakers .

Position of the NewTec WiFi Transmitter:

The best position for the WiFi transmitter is in the middle of the room. For best coverage you should place the transmitter at the height level of the speakers. Keep it at least 5 meters away from any other wireless devices (WiFi router, WiFi phones, WiFi POS systems, etc) which could influence each other.

Unfold in any case the antenna and mount the transmitter, so that the antenna is always in a vertical position (see examples below). Avoid operating with folded antenna or in a horizontal position.

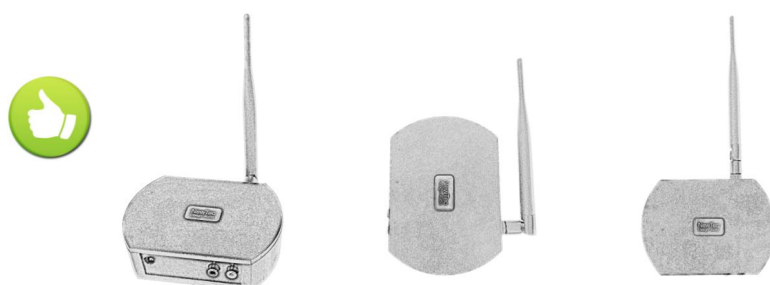

Installation guide WiFi speakers

① CONO canto WiFi:

Clip the CONO canto WiFi speaker into the 3 phase lighting track. If you hear a “plop” from the speaker and the Led is flashing, you are on the correct phase and the speaker is connected to power. If not, turn the phase switch till you hear the “plop” sound => see first page

CONO pendo WiFi:

Install and connect the CONO pendo WiFi to the power supply

SUB quadro WiFi:

Install the SUB quadro WiFi, connect to the power supply and turn the switch on the backside to “ON”

SUB canto WiFi:

Clip the SUB canto WiFi speaker into the 3 phase lighting track. If you hear a “plop” from the subwoofer and the Led is flashing, you are on the correct phase and the subwoofer is connected to power. If not, turn the phase switch till you hear the “plop” sound

Repeat the procedure with all WiFi speakers and control if the LEDs on all speakers are flashing.

② Connect the transmitter to an electrical outlet using the supplied AC adapter. Check that the green and orange LEDs on the transmitter are flashing (if not, check that the power adapter is properly connected and the outlet is supplying power).

③ Connect a player to the Cinch jacks using the supplied audio cable and start playback. When the orange LED is continuously lit, the music is sent wirelessly to the speakers.

The still flashing green LED confirms the correct functioning of the internal sound processor.

④ **CONNECT:** Use the supplied remote control to aim at the orange LED of the transmitter and press the arrow key upwards. As soon as the blue LED is on, the transmitter is in pairing mode.

Pairing mode: The transmitter activates the pairing mode to connect all speakers. Every 15 seconds the transmitter plays the connected music signal for 5 seconds to check a successful connection. This will be repeated until you disable the pairing mode on the transmitter. (see point 6)

⑤ Now go with the remote control from speaker to speaker and aim at the orange LED of the speaker and press the arrow key upwards. The speaker confirms a successful pairing after a short time with a long beep tone.

⑥ Deactivate the pairing mode on the transmitter by using the remote control to aim at the blue LED of the transmitter and press the arrow key downwards. After a few seconds, the transmitter will switch to normal operation and all connected speakers will output the connected music signal. You can start now playing music.

- ⑦ You can adjust the volume of each SINGLE loudspeaker in relation to the other speakers (for example, changing rooms, checkout areas, etc.). Use the remote control to aim at the LED of each speaker. (Note that the "master volume" in the store is controlled by your audio device or via the transmitter).
- ⑧ After the setup of all the speakers and Subwoofers with the transmitter, check the best possible transmission location (see previous page).

SUB quadro WiFi Fine Tuning:



You can control the volume and transient frequency at the control buttons on the back of the subwoofer. Recommended transition frequency: ~ 100 Hz

You can also adjust the volume of each SINGLE subwoofer in proportion to the others even after wall mounting. Use the remote control to aim the subwoofer's bass reflex tube and press the Vol +/- buttons (note that the "master volume" in the store is controlled by your audio device or by the WiFi transmitter.).

SUB canto WiFi Fine Tuning:



While using the SUB canto, we recommend setting the satellite speakers to 80% of the volume using **FACTORY SETTINGS** on the remote control. This will help generate a balanced sound.

Of course, you can also adjust the volume of the subwoofer. To do so, use the remote control to aim the subwoofer's bass reflex tube and press the Vol +/- buttons (note that the "master volume" in the store is controlled by your audio device or by the WiFi transmitter.).

Customer support:

NewTec Design Audio GmbH
Via Negrelli 13/C
39100 Bolzano - ITALY

www.newtec-audio.com
Tel. +39 0471 058065
support@newtec-audio.com